

**Contact us:**

[customerservice@pegpro.com](mailto:customerservice@pegpro.com)

Find us on PegPro.com for additional colors, styles & sizes

**Instructions**



[www.pegpro.com/hook-instructions](http://www.pegpro.com/hook-instructions)



**PEGBOARD HOOKS**

With SNAP-TITE TECHNOLOGY®

Patent Pending

BEFORE STARTING, READ THE INSTRUCTIONS IN FULL OR SCAN THE QR CODE BELOW TO WATCH THE VIDEO.



[www.pegpro.com/hook-instructions](http://www.pegpro.com/hook-instructions)

**Contact us:**

[customerservice@pegpro.com](mailto:customerservice@pegpro.com)

Find us on PegPro.com for additional colors, styles & sizes

**Instructions**



[www.pegpro.com/hook-instructions](http://www.pegpro.com/hook-instructions)



**PEGBOARD HOOKS**

With SNAP-TITE TECHNOLOGY®

Patent Pending

BEFORE STARTING, READ THE INSTRUCTIONS IN FULL OR SCAN THE QR CODE BELOW TO WATCH THE VIDEO.



[www.pegpro.com/hook-instructions](http://www.pegpro.com/hook-instructions)

**Contact us:**

[customerservice@pegpro.com](mailto:customerservice@pegpro.com)

Find us on PegPro.com for additional colors, styles & sizes

**Instructions**



[www.pegpro.com/hook-instructions](http://www.pegpro.com/hook-instructions)



**PEGBOARD HOOKS**

With SNAP-TITE TECHNOLOGY®

Patent Pending

BEFORE STARTING, READ THE INSTRUCTIONS IN FULL OR SCAN THE QR CODE BELOW TO WATCH THE VIDEO.



[www.pegpro.com/hook-instructions](http://www.pegpro.com/hook-instructions)

## Instructions for Use

### Step 1

Detach each grommet.

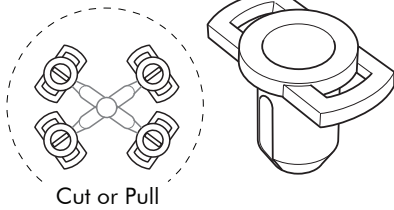

### Step 2

Firmly press the grommet into the pegboard hole where you want the BACK/BOTTOM PIN to snap into.

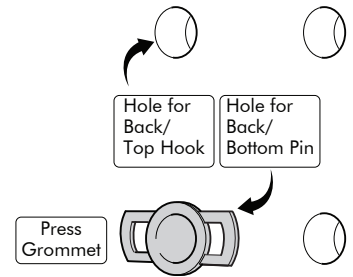

### Step 3

Insert the back/top hook into the hole ABOVE the grommet. Align the back/bottom pin with the grommet.

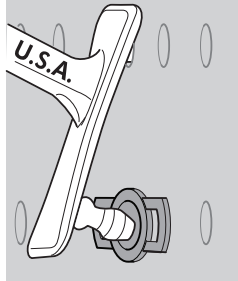

### Step 4

Press the bottom of the hook until the back/bottom pin snaps in place. Continue to press until you hear or feel **2 snaps**.

The base of the hook should lie flat against the peg board.

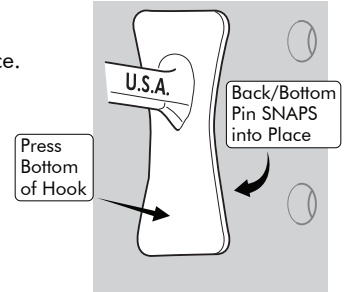

## Instructions for Use

### Step 1

Detach each grommet.

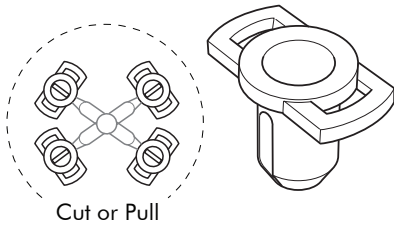

### Step 2

Firmly press the grommet into the pegboard hole where you want the BACK/BOTTOM PIN to snap into.

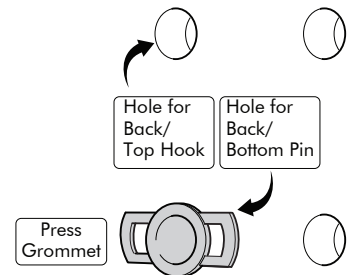

### Step 3

Insert the back/top hook into the hole ABOVE the grommet. Align the back/bottom pin with the grommet.

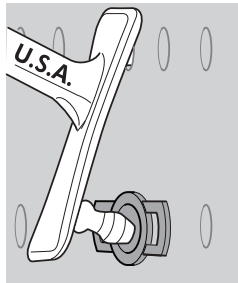

### Step 4

Press the bottom of the hook until the back/bottom pin snaps in place. Continue to press until you hear or feel **2 snaps**.

The base of the hook should lie flat against the peg board.

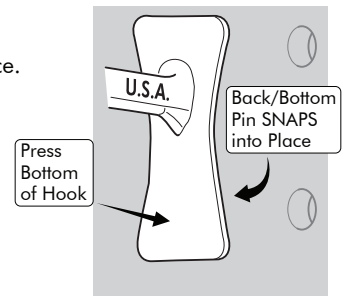

## Instructions for Use

### Step 1

Detach each grommet.

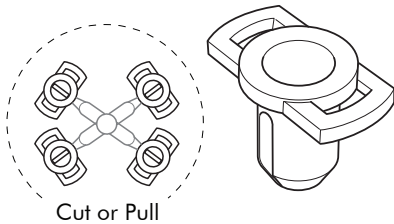

### Step 2

Firmly press the grommet into the pegboard hole where you want the BACK/BOTTOM PIN to snap into.

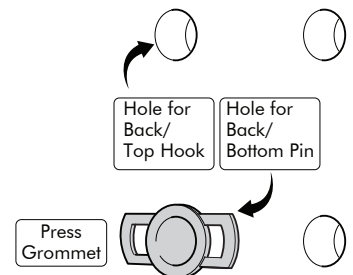

### Step 3

Insert the back/top hook into the hole ABOVE the grommet. Align the back/bottom pin with the grommet.

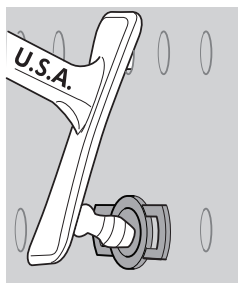

### Step 4

Press the bottom of the hook until the back/bottom pin snaps in place. Continue to press until you hear or feel **2 snaps**.

The base of the hook should lie flat against the peg board.

